

**A compact and versatile forced-air heater!**

This unit is designed for places with limited wall space. Since it works with forced air, it's ideal for entrance halls near the front door, to quickly warm the cold air that enters every time the door opens.

## > Compact Wall Heater

VSG Series



Designed and made  
in CANADA

### MODELS

Product #	Volts	Watts
VSG0500BL	240/208	500/375
VSG1000BL	240/208	1000/750
VSG1500BL	240/208	1500/1125
VSG2000BL	240/208	2000/1500

### OPTIONS

Product #	Description
KIT-VSG-TB6	Single-pole bi-metal thermostat, with a control knob
KIT-VSG-TB26	Double-pole bi-metal thermostat, with a control knob
KIT-VSG-BSBL	Surface mounting box

### WARRANTY

- 1-year against defects

### COLOR CHART

Standard color:



Optional colors (upcharge applicable): *Due to the printing process, the colors may vary from the actual colors.*

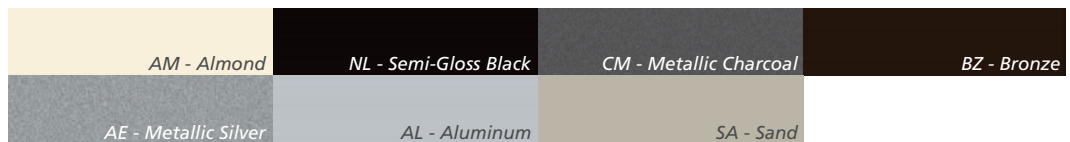



## FEATURES

### FAST AND EASY INSTALLATION

No detail has been overlooked to make installation of this heater as simple as possible.

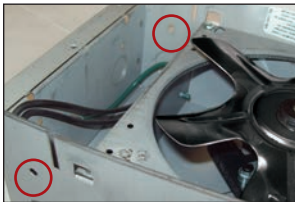

- Mounting holes on the recess box that can be accessed without having to disassemble the unit.
- Large wiring compartment.
- V-shaped recess box to adapt installation to finished walls.

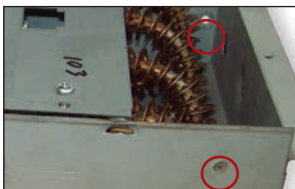

### QUIETER

For better control of air flow and noise level, unit motors vary in accordance with power ratings.

- The 500W and 1000W models are equipped with a 40 cfm motor, which emits a sound level of approximately 38 dBa.
- The 1500W and 2000W are fitted with a 80 cfm motor, which emits a sound level of approximately 41 dBa.

### VERSATILE

- Provides four different mounting positions to accommodate any installation.

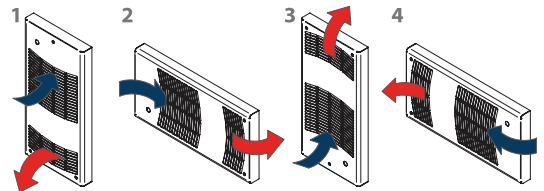

- Can be recessed in a 2 in. X 4 in. or 2 in. X 3 in. wall space or even on the wall surface with a surface mounting box that is sold separately.

### STURDY AND DURABLE CONSTRUCTION



- Durable tubular heating element with fins.
- Baked epoxy/polyester powder coating providing an ultra-durable, easy-to-maintain finish.